

THE
BRILLIA
at 8 Brighton Crescent

8 | 8A | 8B

BRIGHTON CRESCENT

Proudly Developed By



FRX
CAPITAL

7 OCTOBER 2025

SINGAPORE

THE BRILLIA

at 8 Brighton Crescent

Nestled in the mature District 19, Brighton Collection is situated in the popular Serangoon Garden estate, allowing you to take a breather from the hustle and bustle. The site is located within walking distance of Chomp Chomp Food Centre, MyVillage at Serangoon Garden and a whole host of amenities.

Designed for multi-generational living, the development comprises three terraces, two corner terraces with 5 bedrooms and one inter terrace with 4 bedrooms. Each home features well-planned common spaces for various occasions, with the living area opening out to an outdoor decking area, ideal for family gatherings.



Artist's Impression

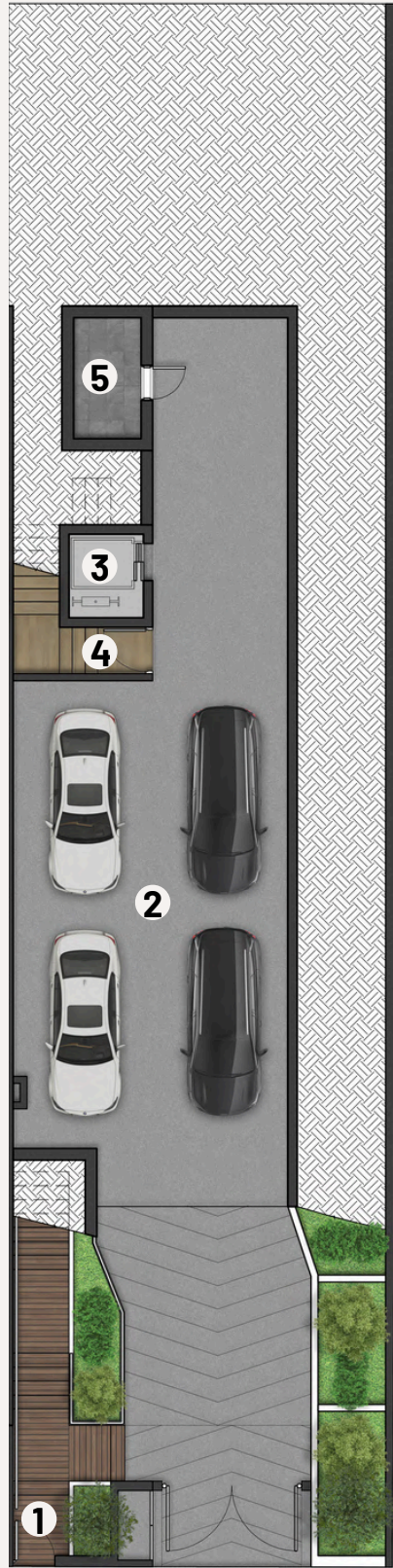

BASEMENT



1ST STOREY



2ND STOREY

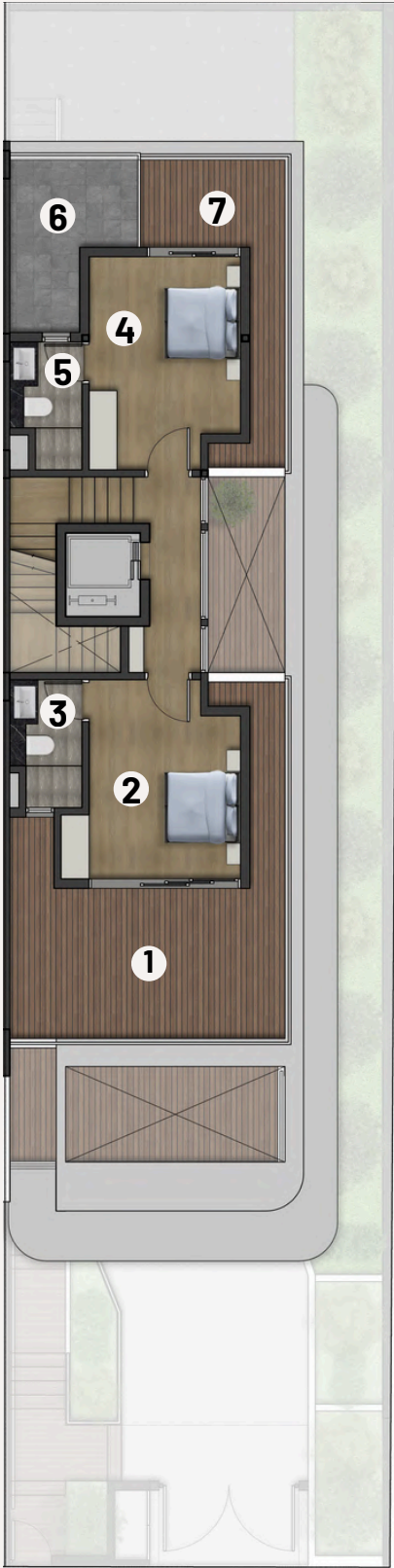

ATTIC



- 1. Side Gate
- 2. Garage
- 3. Lift
- 4. Foyer
- 5. Homeshelter

- 1. Roof Terrace
- 2. Living Room
- 3. Dining Room
- 4. Dry Kitchen
- 5. Wet Kitchen
- 6. Powder Room
- 7. Maid's Room
- 8. Maid's WC
- 9. Laundry
- 10. Yard

- 1. Roof Terrace
- 2. Master Bedroom
- 3. Walk-in Closet
- 4. Master Bathroom
- 5. Side Terrace
- 6. Bedroom 1
- 7. Bathroom 1
- 8. Bedroom 2
- 9. Bathroom 2

- 1. Roof Terrace
- 2. Bedroom 3
- 3. Bathroom 3
- 4. Bedroom 4
- 5. Bathroom 5
- 6. M&E Deck
- 7. Rear Roof Terrace

8
BRIGHTON
CRESCENT

3,018
Est. Land Area
(SQFT)

7,175
Est. Total Build-Up
(SQFT)

5
Bedrooms

5
En-Suite Bathrooms

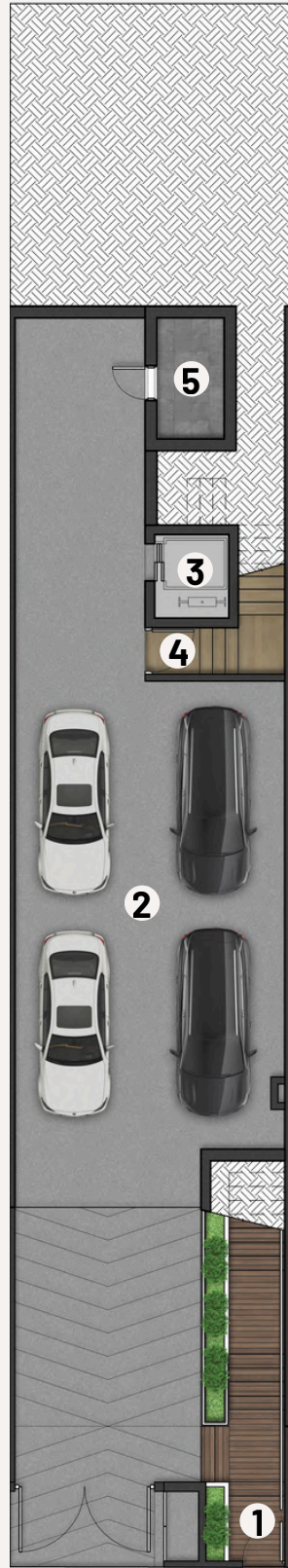

BASEMENT

- 1. Side Gate
- 2. Garage
- 3. Lift
- 4. Foyer
- 5. Homeshelter



1ST STOREY

- 1. Roof Terrace
- 2. Living Room
- 3. Dining Room
- 4. Dry Kitchen
- 5. Wet Kitchen
- 6. Powder Room
- 7. Maid's Room
- 8. Maid's WC
- 9. Laundry
- 10. Yard



2ND STOREY

- 1. Roof Terrace
- 2. Master Bedroom
- 3. Walk-in Closet
- 4. Master Bathroom
- 5. Side Terrace
- 6. Bedroom 1
- 7. Bathroom 1
- 8. Bedroom 2
- 9. Bathroom 2



ATTIC

- 1. Roof Terrace
- 2. Bedroom 3
- 3. Bathroom 3
- 4. Rear Roof Terrace
- 5. M&E Deck

8A

BRIGHTON CRESCENT

2,168

Est. Land Area
(SQFT)

5,955

Est. Total Build-Up
(SQFT)

4

Bedrooms

4

En-Suite Bathrooms



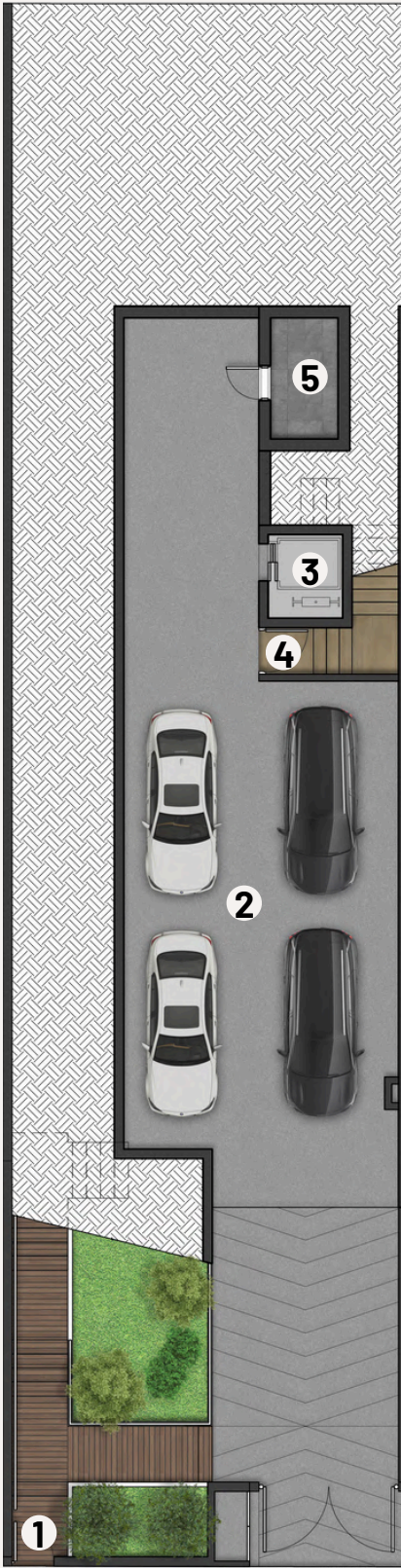

BASEMENT

- 1. Side Gate
- 2. Garage
- 3. Lift
- 4. Foyer
- 5. Homeshelter



1ST STOREY

- 1. Roof Terrace
- 2. Living Room
- 3. Dining Room
- 4. Dry Kitchen
- 5. Wet Kitchen
- 6. Powder Room
- 7. Maid's Room
- 8. Maid's WC
- 9. Laundry
- 10. Yard



2ND STOREY

- 1. Roof Terrace
- 2. Master Bedroom
- 3. Walk-in Closet
- 4. Master Bathroom
- 5. Side Terrace
- 6. Bedroom 1
- 7. Bathroom 1
- 8. Bedroom 2
- 9. Bathroom 2



ATTIC

- 1. Roof Terrace
- 2. Bedroom 3
- 3. Bathroom 3
- 4. Bedroom 4
- 5. Bathroom 5
- 6. M&E Deck
- 7. Rear Roof Terrace

8B

BRIGHTON CRESCENT

3,107

Est. Land Area
(SQFT)

7,256

Est. Total Build-Up
(SQFT)

5

Bedrooms

5

En-Suite Bathrooms





Artist's Impression

LIVING ROOM



Artist's Impression

MASTER BEDROOM

























MASTER BATHROOM

Artist's Impression

WET KITCHEN



PERFECTLY LOCATED

Transport	Serangoon North MRT (U/C)	4 mins	
	Tavistock MRT (U/C)	5 mins	
	Lorong Chuan MRT	6 mins	
	Serangoon MRT	7 mins	
	Kovan MRT	7 mins	
Schools	Zhonghua Primary (< 1 KM)	5 mins	
	CHIJ Our Lady of Good Counsel (< 1 KM)	5 mins	
	Rosyth School (< 2 KM)	6 mins	
	Xinmin Primary (< 2 KM)	7 mins	
	St. Gabriel's Primary (< 2 KM)	7 mins	
	Yangzheng Primary (< 2 KM)	7 mins	
Amenities	Serangoon Garden Market	8 mins	
	Chomp Chomp Food Centre	9 mins	
	myVillage at Serangoon Garden	3 mins	
	Serangoon Gardens Country Club	4 mins	
	The Serangoon Community Club	4 mins	
	New Tech Park	6 mins	
	Hougang 1 / Ci Yuan Community Club	6 mins	
	NEX	7 mins	
	Heartland Mall / Kovan Market & Food Centre	8 mins	
	Serangoon Stadium	3 mins	
	Hougang Sports Centre (U/R)	7 mins	



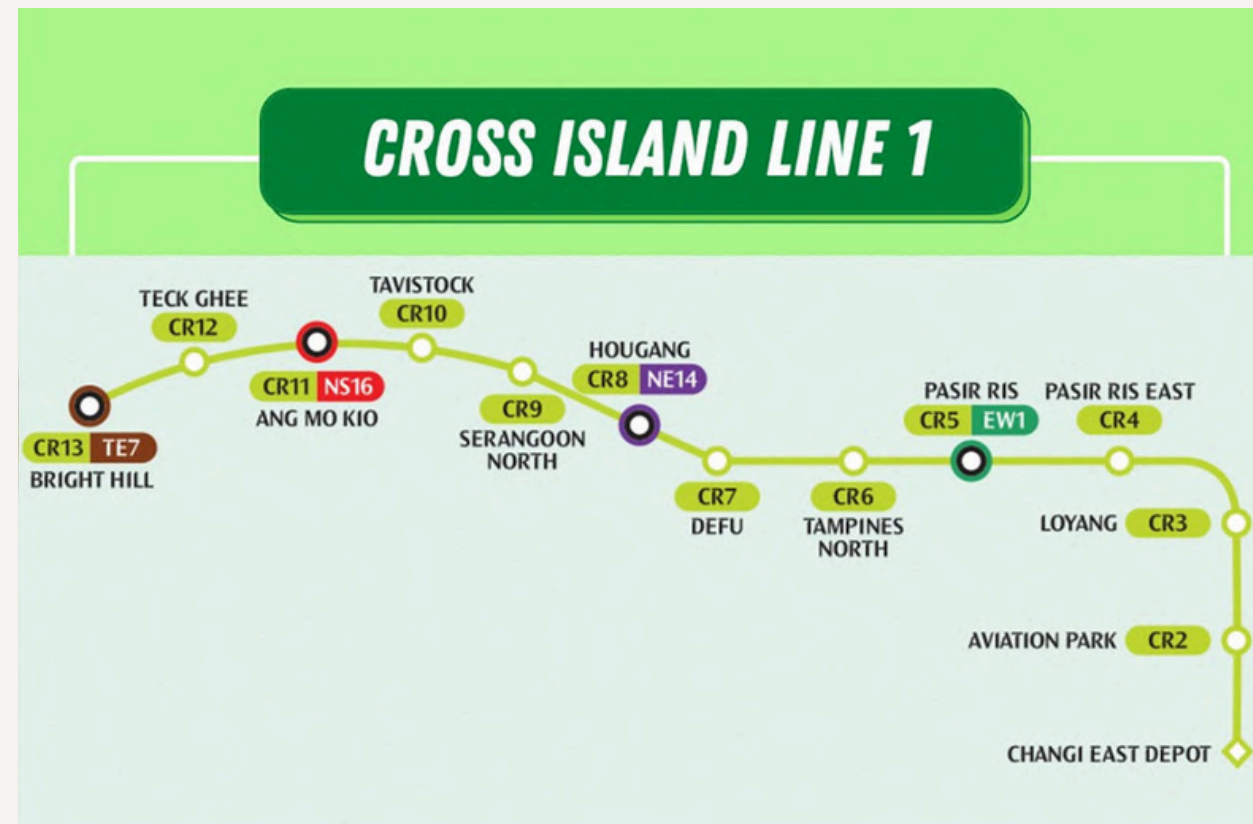

TRANSPORT

Enjoy seamless connectivity with convenient access to bus stops, MRT stations and major expressways.

- Serangoon MRT (North East & Circle Line)
- Lorong Chuan MRT (Circle Line)
- Kovan MRT (North East Line)
- Serangoon North & Tavistock MRT (Cross Island Line, U/C)
- Central Expressway
- Pan Island Expressway

SINGAPORE

TOP SCHOOLS



Rosyth School

Proudly one of Singapore’s 9 exclusive GEP schools that offers a nurturing environment and enriched curriculum for gifted learners.

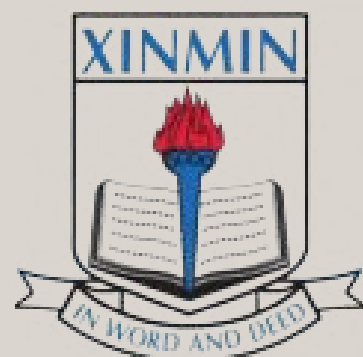

Xinmin Primary School

Committed to holistic development, Xinmin Primary shapes students into Lifelong Learners, Confident Leaders, and Innovative Collaborators ready for the future.



CHIJ Our Lady Of Good Counsel

Rooted in the motto “Simple in Virtue, Steadfast in Duty”, the school instills integrity and a strong sense of commitment.





myVillage at Serangoon Garden

A charming lifestyle mall nestled in the heart of Serangoon Gardens, myVillage offers a curated mix of dining, retail, and daily essentials—all within a welcoming, garden-inspired setting. It's a beloved neighborhood hub that brings convenience and community together in one vibrant location and only 10-minutes walk away from 8 Brighton Crescent.

AMENITIES

Experience the ease of landed Living, with everyday conveniences just moments away.

NEX Shopping Centre

One of Singapore's largest suburban malls, located at the heart of Serangoon and seamlessly connected to the MRT and bus interchange. With over 300 retail, dining, and lifestyle options, it offers unmatched convenience and variety for everyday living.





R.K. Eating House
1 Kensington Park Road
Singapore 557253



Dessert Bowl
80A Serangoon Garden Way
Singapore 555976



Monzen@Gardens
82 Serangoon Garden Way
Singapore 555978



Pow Sing Kitchen
59 Serangoon Garden Way
Singapore 555961

GASTRONOMIC DIVERSITY

Mention Serangoon Garden and most people will think of the famous Chomp Chomp Food Centre or Serangoon Garden Market & Food Centre. The food scene in Serangoon Garden does not end there, it features a wide range of different eateries and cuisines, for any occasion.



SERANGOON GARDEN MARKET

Serangoon Garden is a food enclave with not one but two Hawker Centres, which are less than 200 meters apart. Serangoon Garden Market is a breakfast and lunch place in the neighbourhood, which also consists of a wet market.

CHOMP CHOMP FOOD CENTRE

Chomp Chomp Food Centre is popular as a supper place, good especially when you have the occasional late-night cravings for Hokkien Mee, Satay and Chicken Wings.





LIFESTYLE & RECREATION



Serangoon Stadium

A local venue at the heart of Serangoon



Hougang Sports Centre (U/R)

A dynamic hub for fitness, sports and community bonding



Mount Rosie Signature Collection



Artist's Impression

The Hillshore

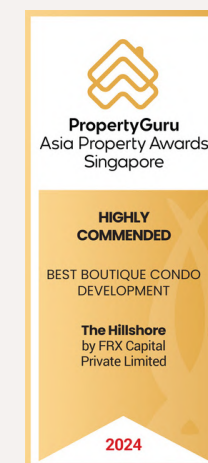

AWARD WINNING DEVELOPER

TRACK RECORD



3 Merino Crescent

Nestled in the mature District 3, 3 Merino Crescent is situated in the prestigious Shepherds Hill Estate



56 Kingswear
Avenue

Nestled in Serangoon Gardens, 56 Kingswear offers calm in vibrant District 19



6 & 8 Jalan
Novena Selatan

A pair of semi-detached homes in Novena, located near ACS Primary and SJI Junior, perfect for families



Haig Villas

With eateries and recreation just a walk away, Haig Villas' prime location offers endless food and fun

DEVELOPED BY

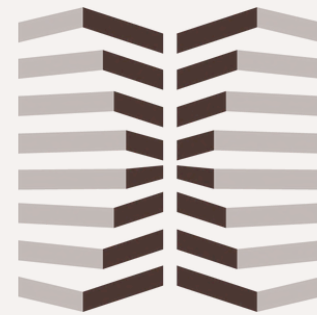

FRX CAPITAL



8023 2928



www.frxcapital.com.sg



101 Cecil Street, #26-08/12, S069533

Disclaimer:

While all reasonable care has been taken in preparing this brochure, the Developer and agents shall not be held responsible for any inaccuracies or omissions, including but not limited to any variations arising from any change of facts or circumstances occurring after the date of print of this brochure. All visual representations including models, drawings, photographs, art renderings and illustrations are intended to portray only an artist's impression of the development and shall not be granted as representations of fact. All information, specifications, renderings, visual representations and plans are current at the time of print of this brochure and are subject to such changes as may be required by the Developer and/or required or approved by the relevant authorities and notified to the Developer after the date of print of this brochure and shall not form part of any offer or contract nor constitute any warranty by the Developer. All floor areas and other measurements are approximate measurements only and are subject to final survey. The Sale and Purchase Agreement shall form the entire agreement between the Developer and the purchaser and supersedes and cancels in all respects all previous representations, warranties, promises, inducements or statements of intention, expressions of opinion, whether written or oral made by the Developer and/or its agents which are not embodied in the Sale and Purchase Agreement, unless approved by the Controller of Housing and expressly agreed to in writing between the parties.